

**MATERIALS OF CONSTRUCTION\***  
 CUSTOM 180° - COPPER  
 HOSE & BRAID - BRONZE  
 90° ELBOWS - COPPER  
 \*OTHER MATERIALS AVAILABLE

The wetted surface of this product contacted by consumable water contains less than one quarter of one percent (0.25%) of lead by weight. Material complies with state codes and standards, where applicable, requiring reduced lead content.

NOTE: METRALOOPS 2" AND LARGER INSTALLED IN ANY ORIENTATION OTHER THAN HANGING DOWN MUST HAVE THE 180° RETURN SUPPORTED. (SEE INSTALLATION INSTRUCTIONS.)

CONTACT FACTORY FOR ADDITIONAL SIZES AND MOVEMENTS. ALL DIMENSIONS IN INCHES.

QTY	SIZE	MODEL	MVMT	A	B	PSI*	WT (LBS)	SPRING FORCE**	PROJECT INFO
	1/2"	MLS80050	±4"	7-3/4"	15-3/8"	706	2.5	45	
	3/4"	MLS80075	±4"	9-1/2"	17-1/4"	577	2.5	47	
	1"	MLS80100	±4"	10-1/4"	19-1/4"	470	3	53	
	1-1/4"	MLS80125	±4"	11-1/8"	21-3/8"	361	4	66	
	1-1/2"	MLS80150	±4"	11-5/8"	22-1/2"	329	4.5	70	
	2"	MLS80200	±4"	13-3/8"	24-3/4"	317	12	78	

\*Working pressure listed is the rating at 70 F. Contact factory for other pressure ratings at other temperatures and for steam applications.

\*\*Spring force: The total force (Lbs) required to move the Metraloop its full rated movement for 150 PSI @ 70 F.

CUSTOMER: \_\_\_\_\_

PROJECT: \_\_\_\_\_

ENGINEER: \_\_\_\_\_

REV.	DATE
2323 W. HUBBARD ST. CHICAGO, IL 60612 TEL: 312-738-3800 FAX: 312-738-0415 WWW.METRAFLEX.COM	
<b>METRALOOP MODEL MLS</b> <b>SWEAT ENDS, ±4" MOVEMENT</b>	
DRAWN BY: <b>DKISH</b>	DATE: <b>10/31/2018</b>
APPROVED: <b>JC</b>	DATE: <b>10/31/2018</b>
SCALE: <b>NTS</b>	DRAWING NUMBER: <b>MLS80050-200</b>

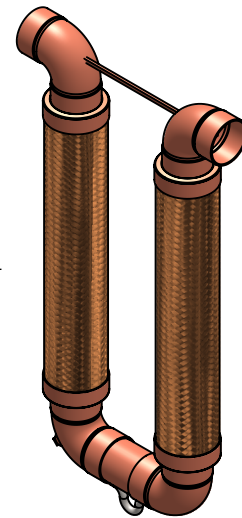
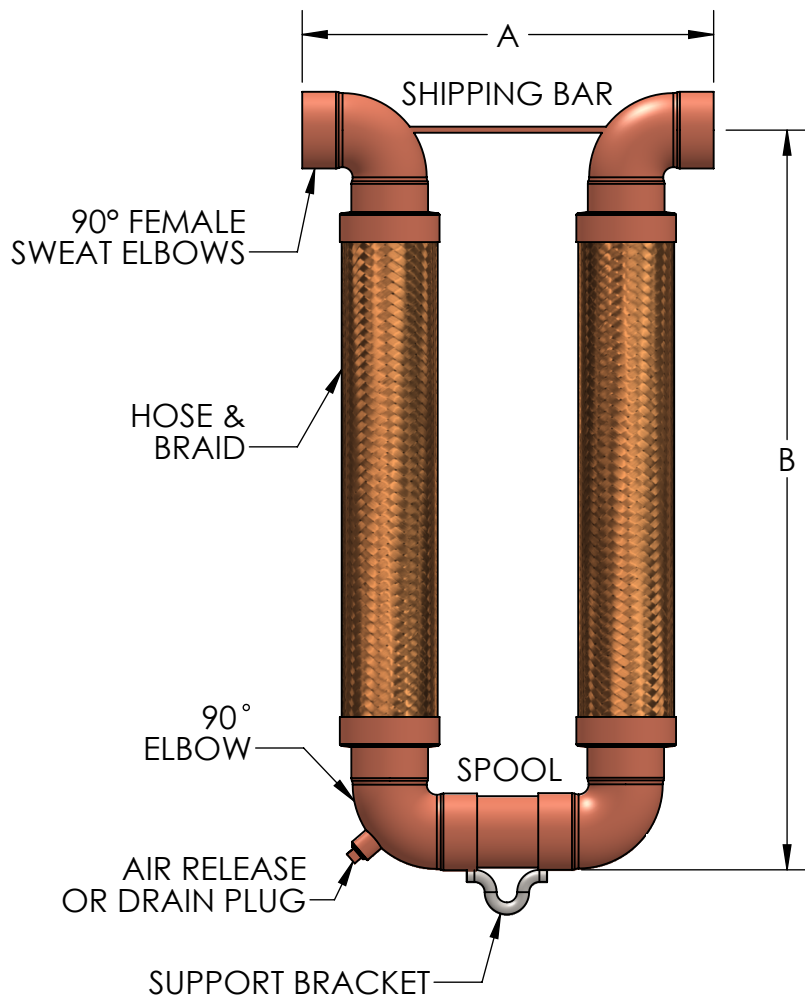

#### MATERIALS OF CONSTRUCTION\*

HOSE & BRAID - BRONZE

90° ELBOW - COPPER

SPOOL - COPPER

\*OTHER MATERIALS AVAILABLE

The wetted surface of this product contacted by consumable water contains less than one quarter of one percent (0.25%) of lead by weight. Material complies with state codes and standards, where applicable, requiring reduced lead content.

NOTE: METRALOOPS 2" AND LARGER INSTALLED IN ANY ORIENTATION OTHER THAN HANGING DOWN MUST HAVE THE 180° RETURN SUPPORTED. (SEE INSTALLATION INSTRUCTIONS.)

CONTACT FACTORY FOR ADDITIONAL SIZES AND MOVEMENTS. ALL DIMENSIONS IN INCHES.

QTY	SIZE	MODEL	MVMT	A	B	PSI*	WT (LBS)	SPRING FORCE**	PROJECT INFO
	2-1/2"	MLS80250	±4"	17"	26-1/2"	272	18	83	
	3"	MLS80300	±4"	18-1/2"	28-1/2"	201	24	90	
	4"	MLS80400	±4"	22"	32"	142	31	120	

\*Working pressure listed is the rating at 70 F. Contact factory for other pressure ratings at other temperatures and for steam applications.

\*\*Spring force: The total force (Lbs) required to move the Metraloop its full rated movement for 150 PSI @ 70 F.

REV.	DATE
<b>Metraflex</b> <i>for pipes in motion</i>	
2323 W. HUBBARD ST. CHICAGO, IL 60612 TEL: 312-738-3800 FAX: 312-738-0415 WWW.METRAFLEX.COM	
<b>METRALOOP MODEL MLS</b> SWEAT ENDS, +/- 4" MOVEMENT	
DRAWN BY: <b>DKISH</b>	DATE: <b>10/31/2018</b>
APPROVED: <b>JC</b>	DATE: <b>10/31/2018</b>
SCALE: <b>N/A</b>	DRAWING NUMBER: <b>MLS80250-400</b>

CUSTOMER: \_\_\_\_\_

PROJECT: \_\_\_\_\_

ENGINEER: \_\_\_\_\_